

ASSEMBLY INSTRUCTIONS

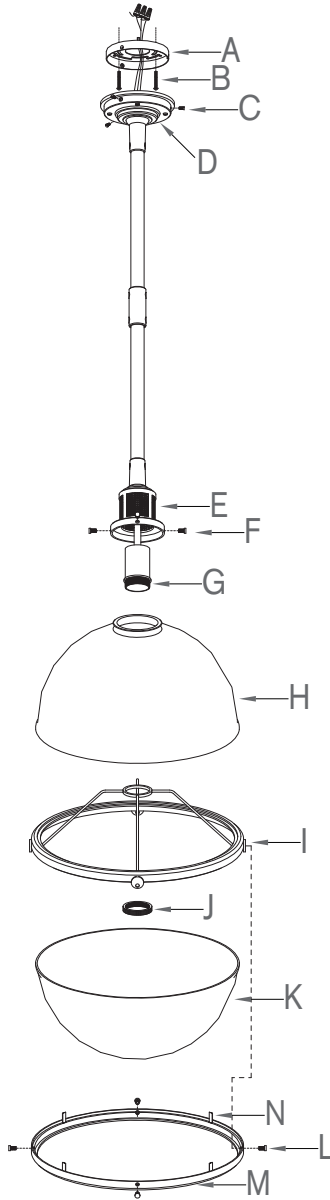

McCarren Large Globe Pendant

Item # RL 5461

NOTICE:

This light fixture should be installed in accordance with all applicable, local installation codes, and by a person familiar with the construction and operation of it, as well as the hazards involved. Inspect item and contents carefully. If any damage or defect is found, do not install. Retain all packaging material until installation is complete and approved.

1. Carefully remove all parts from the carton.
2. Remove mounting plate (A) from base of light fixture (D) by removing base screws (C) in counter-clockwise direction.
3. Affix mounting plate (A) to ceiling outlet box with mounting screws (B) provided.
4. Attach the bare copper ground from the fixture to the ground junction box wire (usually green or copper), fasten together with a plastic wire connector. Tightly wrap the wire connector with electrical tape. Be sure no wire strands are exposed. **IT IS IMPERATIVE THAT THE OUTLET BOX IN YOUR HOME BE PROPERLY GROUNDED.**
5. Connect neutral wire from fixture (ribbed molded wire) to the neutral wire from the junction box (usually white). Fasten both wires together with a plastic wire connector and tightly wrap the wire connector with electrical tape. Be sure no wire strands are exposed.
6. Connect the hot wires from the fixture (smooth wire) to the hot wire (usually black) from the junction box. Fasten both wires together with a plastic wire connector and wrap the connection with electrical tape. **DO NOT REVERSE THE HOT AND NEUTRAL CONNECTIONS OTHERWISE SAFETY WILL BE COMPROMISED.**
7. Tuck the wire connections neatly into the ceiling outlet box.
8. Attach fixture base (D) to the affixed mounting plate (A) and tighten with base screws (C).

RALPH LAUREN



ASSEMBLY INSTRUCTIONS

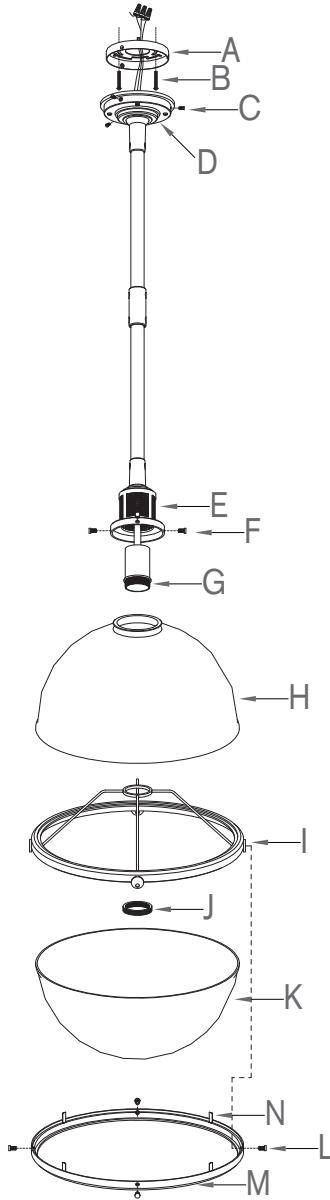

McCarren Large Globe Pendant

Item # RL 5461

NOTICE:

This light fixture should be installed in accordance with all applicable, local installation codes, and by a person familiar with the construction and operation of it, as well as the hazards involved. Inspect item and contents carefully. If any damage or defect is found, do not install. Retain all packaging material until installation is complete and approved.

9. Insert glass shade (K) into metal ring (M) and secure by bending back the metal tabs (N) downwards.
10. Loosen screws (F), attach glass shade (H) to shade holder (E) and secure with screws (F). DO NOT OVER TIGHTEN OTHERWISE GLASS WILL BE DAMAGE.
11. Remove socket ring (J) from threaded socket (G), attach bracket (I) to the threaded section of socket and secure with socket ring (J).
12. Insert light bulb (not included) into the socket.
13. Remove screws (L), attach metal ring (M) with glass shade (K) to bracket (I) and secure by replacing screws (L).

Care Instructions: Clean only with a soft dry cloth or feather duster. Do not use abrasive or chemical agents.

RALPH LAUREN

